



# ROBINSON HOUSES

LANDSCAPE DESIGN CHARRETTE - 2023.06.28

terrain | Harlem PACT Partners

terrain | ROBINSON HOUSES



# INTRODUCTION **AGENDA**

## WORKSHOP AGENDA 6:00PM-8:00PM

- 6:00-6:15 PM INTRODUCTION BY VAYA TEAM & PACT PROCESS
- 6:15-6:30 PM INTRODUCTION OF THE TERRAIN TEAM & PROJECT
- Introduce the firm and role on the project
  - Review existing site conditions & concerns
- 6:30 -7:15PM BREAKOUT SESSIONS
- Residents will discuss needs, desires, and site improvements in small groups at breakout tables
  - Breakout tables will note topics on the plans for the design team to review
- 7:15-7:45 PM RESIDENT SPEAKERS
- Each breakout table will delegate a resident as representative to share the main topics of their discussion with the larger workshop group
- 7:45-8:00 PM WRAP-UP & CLOSING COMMENTS
- Terrain will summarize conversations heard today & how to proceed
  - Residents are reminded to please turn in their Resident Surveys, drawing notes, and to add their comments to the Wall Boards
  - Closing comments from development team





INTRODUCTION



WEBSTER AVENUE, BRONX

terrain | ROBINSON HOUSES







INTRODUCTION



**BAYCHESTER HOUSES, BRONX**

terrain | ROBINSON HOUSES







## HOW DO YOU FEEL...

- WHEN YOU STEP OUTSIDE YOUR BUILDING?
- WHEN YOU WALK HOME AT NIGHT?
- WHEN YOU SIT OUTSIDE & RELAX?
- WHEN YOU USE THE PLAY EQUIPMENT?



SITE OVERVIEW  
**EXISTING SITE**

**QUICK FACTS**

- **COMPLETED IN 1973**
- **1.49 ACRE SITE**
- **8-STORY BUILDING**
- **189 APARTMENTS**
- **414 RESIDENT POPULATION**

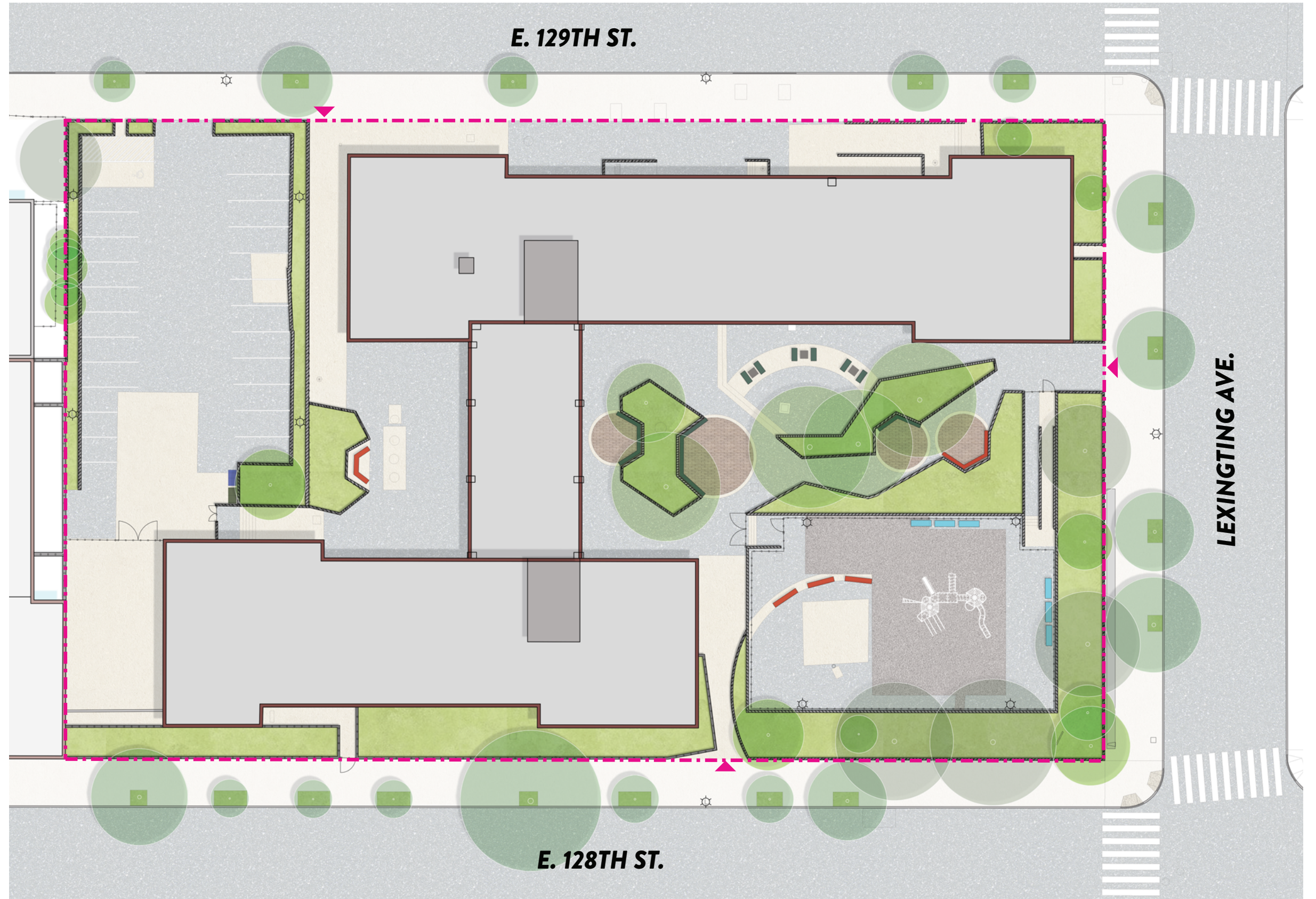



**SUMMARY**

- **SEVERAL PROGRAM SPACES EXIST, HOWEVER THEY ARE NOT OPTIMIZED**
- **SITE IS ELEVATED FROM THE SIDEWALK; MULTIPLE STAIRS AND RAMPS REQUIRED TO ACCESS THE SITE**
- **MULTIPLE SMALL SEATING AREAS EXIST, HOWEVER THEY OFFER A SIMILAR SEATING EXPERIENCE**

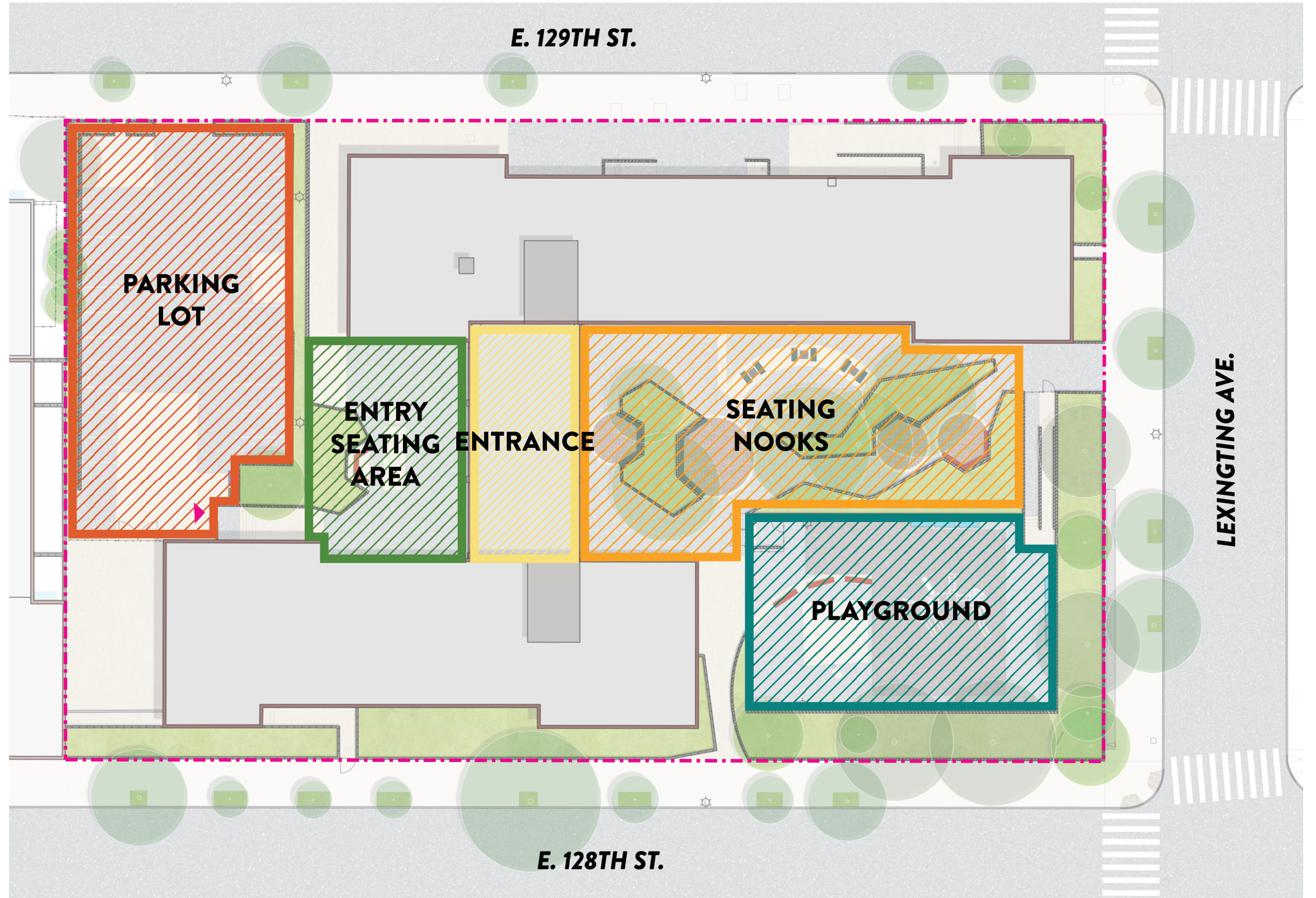



# WHAT DO YOU LIKE ABOUT THE OUTDOOR SPACE...?

- SEATING AREAS
- PLAYGROUND AREA
- CONNECTION TO THE NEIGHBORHOOD
- TREES / GREEN SPACE



# WHAT COULD BE BETTER...?

- SITE ACCESSIBILITY
- SECURITY / LIGHTING
- PLAY / ATHLETIC SPACES
- WASTE MANAGEMENT
- DRAINAGE
- PARKING



**SITE IMPROVEMENT  
ENTRANCES & ORGANIZATION**

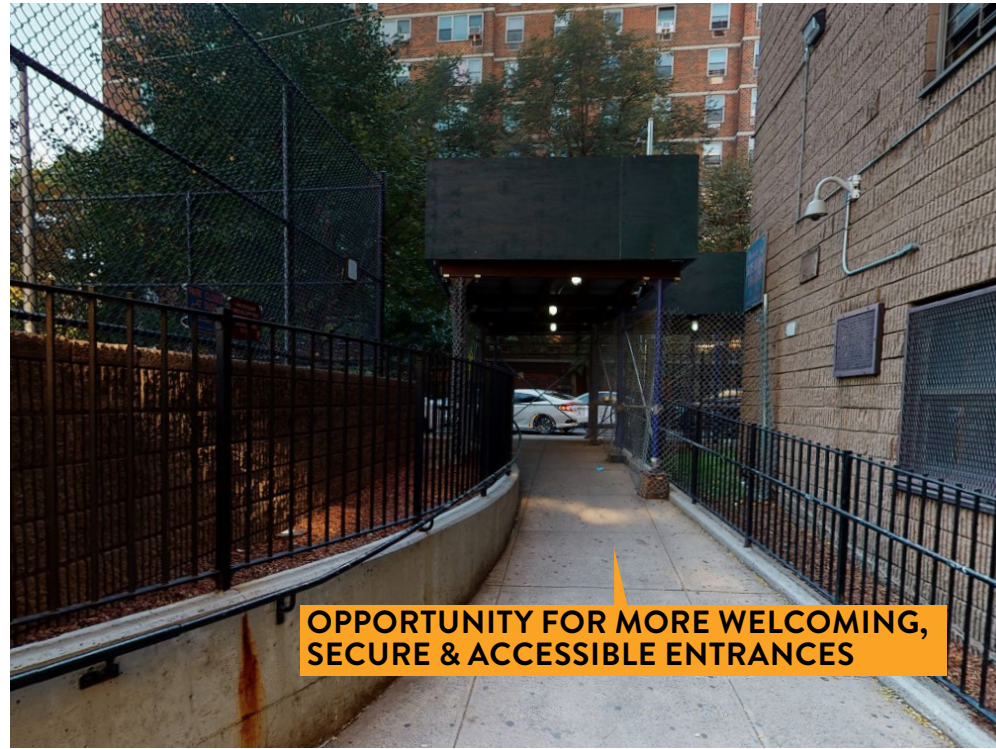

**EXISTING CONDITIONS  
POTENTIAL DESIGN IDEAS**



- ENHANCED PLANTINGS AND PAVING AT ENTRANCES
- MORE ORGANIZED WASTE MANAGEMENT



- REORGANIZED PAVING AND PLANTINGS AT SEATING PLAZAS



- ACCESSIBLE STAIRS, RAMPS, & NEW PLANTINGS AT DOORS



SITE IMPROVEMENT  
**GATHERING & SOCIAL SPACES**



**EXISTING CONDITIONS**  
**POTENTIAL DESIGN IDEAS**



- PROVIDE NEW FURNISHING AND A VARIETY OF SEATING ARRANGEMENTS



- ENHANCED PAVING AND FURNISHINGS WITH NEW MATERIALS AND COLOR



- DYNAMIC PLANTINGS & INTEGRATED, MULTI-PURPOSE SEATING CONFIGURATIONS



**SITE IMPROVEMENT  
PLAYGROUND SPACE**



**EXISTING CONDITIONS  
POTENTIAL DESIGN IDEAS**



GLAZER FAMILY PLAYGROUND (ST. PETERSBURG, FL)

- **UPDATED PLAY EQUIPMENT AND SAFE, COLORFUL RUBBERIZED PLAY MOUNDS**



BAYCHESTER HOUSES (BRONX, NY)

- **PROVIDING A DYNAMIC AND SAFE PLAYING SURFACE**



BAYCHESTER HOUSES (BRONX, NY)

- **NEW SPLASH PAD DESIGN AND SAFE PLAY SURFACE**



**SITE IMPROVEMENT  
TREES & PLANTING**



**EXISTING CONDITIONS  
POTENTIAL DESIGN IDEAS**



- **CANOPY TREES WITH ENHANCED UNDERSTORY LAYER OF SHRUBS AND PERENNIALS**



- **INTRODUCING A VARIETY OF SHRUBS AND PERENNIALS FOR SEASONAL INTEREST**



- **NEW PLANTING ARRANGEMENT AND SEATING NOOKS**



**THANK YOU!**

**WHAT IS YOUR VISION FOR THE FUTURE  
LANDSCAPE AT ROBINSON HOUSES?**